



CARNLEA
— WOOD —

MONKSTOWN ROAD
NEWTOWNABBEY
BT37

THE
DENBEIGH

THE DENBEIGH

Total Floor Area
766 sq ft approx.

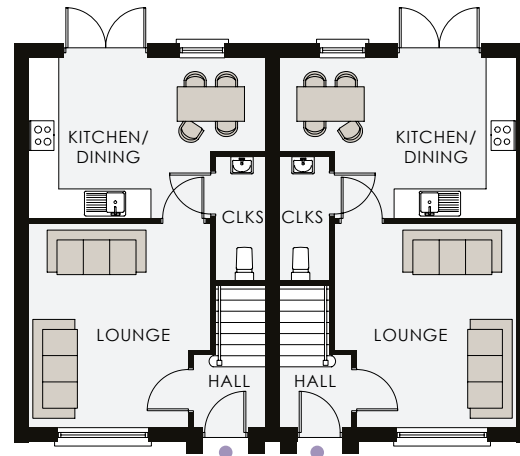

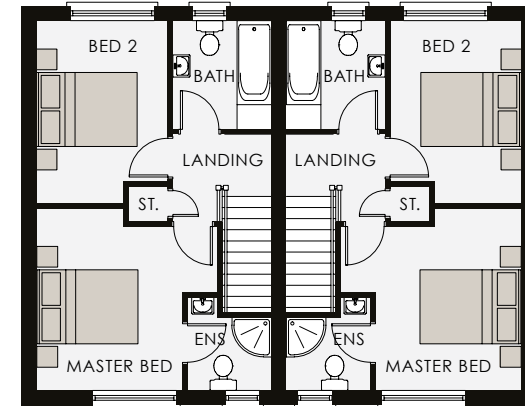

GROUND FLOOR



FIRST FLOOR

TYPE FP1

CARNLEA
— WOOD —
MONKSTOWN ROAD
NEWTOWNABBEY
BT37

Reeds Rains
• Since 1868 •

GLENGORMLEY
Telephone 028 9084 3427
www.reedsrains.co.uk

GROUND FLOOR

Entrance Hall	
Lounge	13'6" x 11'11"
Kitchen / Dining <small>Max</small>	15'6" x 10'8"
Cloakroom	7'2" x 3'3"

FIRST FLOOR

Master Bed <small>Max</small>	12'2" x 11'10"
Ensuite <small>Max</small>	6'2" x 5'6"
Bedroom 2 <small>Max</small>	11'11" x 8'8"
Bathroom	7'2" x 6'6"
Store	

