



CARNLEA  
— WOOD —

MONKSTOWN ROAD  
NEWTOWNABBEY  
BT37

# THE CRANLEIGH

# THE CRANLEIGH

Total Floor Area  
1,185 sq ft approx.  
With Sunroom

1,087 sq ft approx.  
Without Sunroom

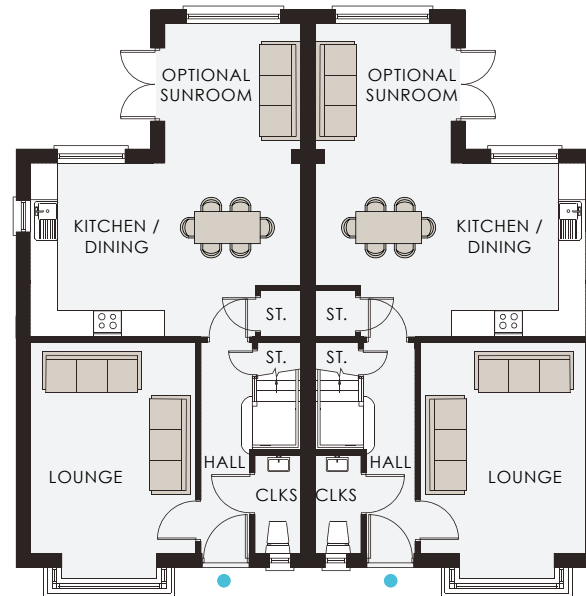

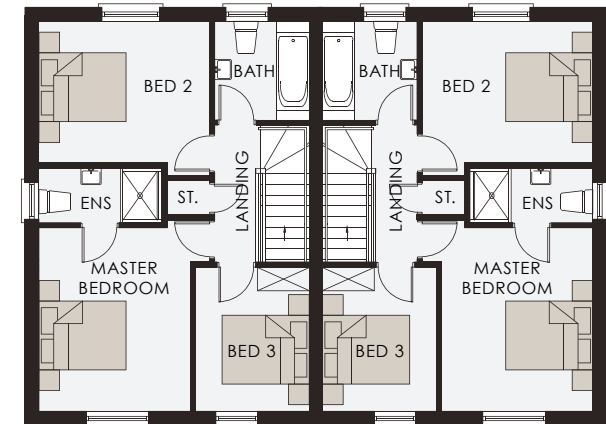

**GROUND FLOOR**



**FIRST FLOOR**

TYPE G.1

  
**CARNLEA  
— WOOD —**  
MONKSTOWN ROAD  
NEWTOWNABBEY  
BT37  
  
**Reeds Rains**  
— Since 1868 —  
GLENGORMLEY  
Telephone 028 9084 3427  
[www.reedsrains.co.uk](http://www.reedsrains.co.uk)

## GROUND FLOOR

Entrance Hall with Store	
Cloakroom	7'0" x 3'3"
Lounge into Bay	16'10" x 11'9"
Kitchen / Dining Max	19'3" x 12'4"
Store in Kitchen	3'4" x 2'10"
Optional Sunroom	9'11" x 9'8"

## FIRST FLOOR

Master Bed Max	13'1" x 10'9"
Ensuite	8'9" x 3'10"
Bedroom 2 Max	12'1" x 10'11"
Bedroom 3 Max	10'3" x 8'1"
Bathroom	7'0" x 6'9"
Store	

